



No Reward Without Effort



YEAR 7 HANDBOOK

2025

Be Respectful Be Responsible Be Cooperative

Effective: Term 4, 2024

Review Date: Term 3, 2025

Table of Contents

Principal's Welcome	4
Introduction 2025 Year Adviser	5
School Map	6
Staff at Broken Hill High School	7
Roles and Responsibilities	8-12
First day of School!	13
Book Pack/School Equipment	13
School bell times	14
Attendance - What to do when:	
you have been away	15
you arrive to school late	15
you feel sick at school	15
you need to leave early from school	15
you need regular medication	16
organising a Bus Pass	16
Anti-social Behaviour	17
Emergency Procedures	18
Communication	18
Newsletter	18
Homework	18
Leadership – SRC	19
Peer Support Program	19
Parent/Teacher Nights	19
Reports	20
Vaccinations	20
Subject Explanations:	
☐☐ English	21
☐☐ Mathematics	22
☐☐ Science	23
☐☐ HSIE	24
☐☐ PD/H/PE	25
☐☐ Sport	26
☐☐ Language	27
☐☐ Music	28
☐☐ Technology	29
The Support Unit	30
The School Student Wellbeing and Behaviour System	31
School Core Values	32
Mobile Phone Policy	33
The School Library	34
School Uniform Information	35-36
School Contributions	37
Parents and Citizens Association	38
Canteen Price List	39
Canteen Volunteering	40



Principal's Welcome

Welcome to Broken Hill High School.

Broken Hill High School has a long tradition of academic, cultural, and sporting excellence. The school offers an extensive academic and extra curricula curriculum. School should be rewarding as well as fun. We hope that you will enjoy your time with us and look back at this time with pride.

Congratulations on making your move to high school. You will have many more teachers than previously. There will be teachers for English, Mathematics, Science, HSIE, PD/H/PE, LOTE, Music and Technology. Your teachers will be in separate staff rooms according to the subjects they teach and the areas where they have their classrooms.

The day at Broken Hill High School is broken up into six separate periods on Monday, Wednesday, Thursday, and Friday. On Tuesday the day is broken up into five separate periods. At the end of most periods, you will move to another classroom for another subject.

Our school day is longer at high school than at primary school. On Monday, Wednesday, Thursday and Friday school begins at 9:00 am and concludes at 3:28 pm. On Tuesday school begins at 9:00 am and concludes at 2:35 pm.

Finally, if you have any problems, please tell someone. We are all here to make your transition from primary school to high school a pleasant and enjoyable experience. Year Advisers, Head Teachers, the Deputy Principal, and I am here to help you.

Welcome to Broken Hill High School!

Mr Ross Mackay
Principal

Vision

A caring inclusive school where students are supported to reach their potential in a changing world.



Year Adviser's Welcome

Welcome to Broken Hill High School. Beginning high school can be both an exciting and daunting experience for students and their parents/carers. At Broken Hill High School, we have tried to make this transition from primary school to secondary school as stress free and enjoyable as possible.

As a school we endeavour not only to provide our students with the best possible education, but to provide a holistic approach to learning where all the students' needs are met. As a school we recognise the welfare needs of students and have these at the centre of all our policies.

We have put together this handbook with the aim of providing you with some of the general information and procedures that at some stage throughout high school might be helpful for you. There are also a number of the subject outlines provided for you about all the subjects you will be studying in Year 7.

As the Year 7 Adviser it is my role to ensure that you settle into high school. I will guide and support you throughout the year. I understand that coming to high school can be quite overwhelming and if you have any problems, you are able to come and see me for help.

I look forward to meeting all of you over the next few months and starting Year 7 in 2025!

Mr Jake Phelan
Year 7 Adviser 2025

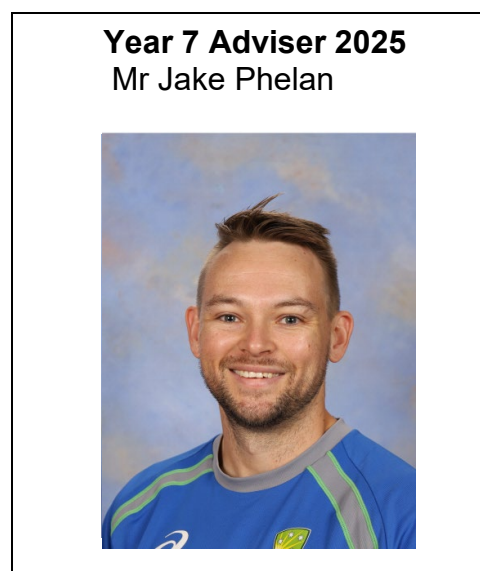

Broken Hill High School Map

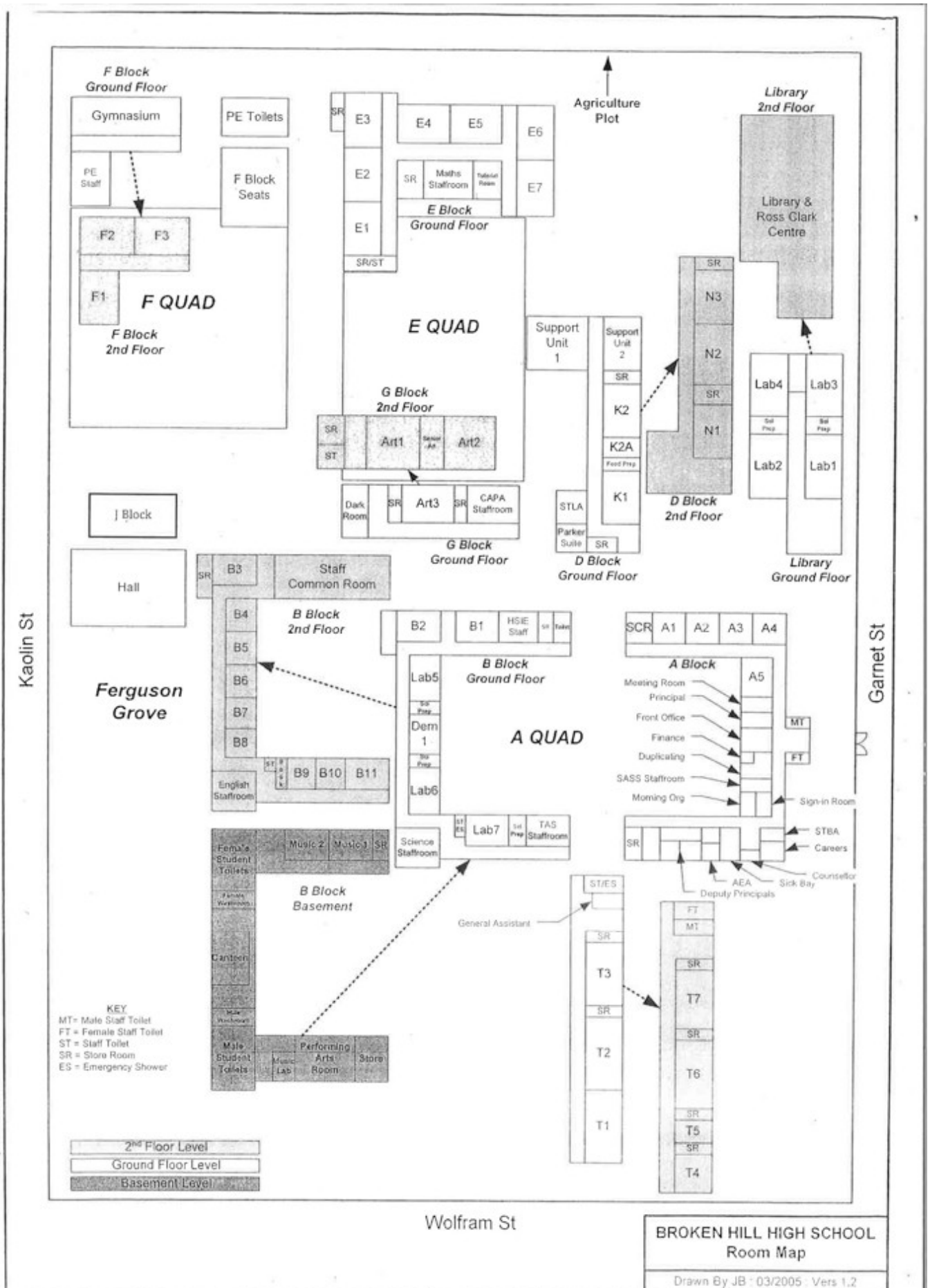

Staff at Broken Hill High School

The members of staff shown below can be contacted through the Front Office.

The School email address is brokenhill-h.school@det.nsw.edu.au

The School phone number is 08 8088 1522.

Principal

Mr Ross Mackay



The **Principal**, Mr Ross Mackay, is responsible for the organisation, management, supervision and efficiency of the school. Parents/Carers and students who wish to discuss issues with the Principal can make appointments through the Front Office.

Deputy Principal

Mr Adam Rhodes



Deputy Principal (Acting)

Ms Annie Bourke



Deputy Principal

Mr Toby Fibbins



The **Deputy Principals**, Mr Adam Rhodes (Years 7 and 9), Ms Annie Bourke (Years 10 and 12) and Mr Toby Fibbins (Years 8,11 and Support Unit) are responsible for the efficient operation of school organisation and the general supervision of staff and pupils. They assist the Principal in the development of teaching programs and curriculum planning. They share matters relating to school discipline and the welfare of the students. Parents/Carers and students who wish to discuss issues with the Deputy Principal can make appointments through the Front Office.

Head Teachers

English/LOTE
Mr Clinton Jones



Mathematics
TBA

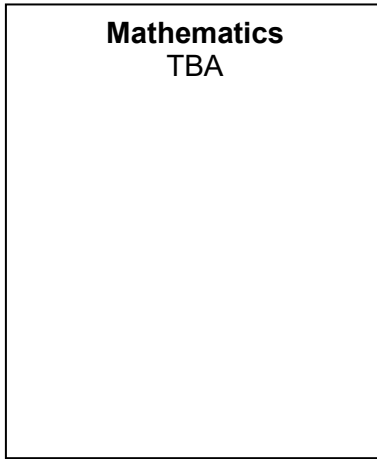

Science (Rel)
Miss Belinda Coen



H.S.I.E
Mrs Heidi Rhodes



PD/Health/PE
Miss Sarah Gillespie



TAS/CAPA
Mr Jason Bradley



Support Unit
Mrs Kristie O'Neill



Admin/Teaching & Learning
Ms Annie Bourke



Head Teachers are responsible for the planning and teaching of the courses of study provided in each of their respective subjects. They place students in appropriate levels and are responsible for determining student progress and assessment. They are available by appointment for discussions with parents/carers and students.

Wellbeing Team

**Head Teacher
Welfare (Rel)**
Miss Phoebe Knell



The **Head Teacher Welfare**, Miss Phoebe Knell, assists the Principal and Deputy Principal in ensuring the welfare and safety of students through the monitoring of attendance and the implementation of whole school welfare programs.

School Counsellor
Miss Daisy Collins



School Counsellor
Mr Joshua Dey



The **School Counsellors**, Mr Josuha Dey, Miss Daisy Collins and Mrs Rachel Harvey are someone you can see during school time to talk over any special problems you may have. These special problems may be feeling uncertain, confused, or unhappy because of personal worries, family situations or study difficulties.

School Counsellor
Mrs Rachel Harvey



Year 7 Adviser 2025
Mr Jake Phelan



The **Year 7 Student Adviser**, Mr Jake Phelan is responsible for the personal welfare of the students in Year 7 including checks on progress, attendance, behaviour and if necessary, contacting parents/carers. Students should always feel free to approach the Year Adviser. Parents/Carers, by appointment, may obtain a full report on the progress, conduct and adjustment of their child/ward from the Year Adviser. Parents/Carers are encouraged to meet the Year Adviser and should feel free to make contact when necessary.

Sports Coordinator
Mr Jake Phelan



The **Sports Coordinator**, Mr Jake Phelan organises all timetabled sport for Years 7-10. Sport at Broken Hill High for Year 7 is conducted once a fortnight. Swimming, Cross Country and Athletics Carnivals are held in Semester 1.

The school is divided into **4 Houses**.

House	Colour
Burke	Purple
Sturt	Red
Parkes	Green
Wills	Blue

Careers Adviser
Mr Brian Bates

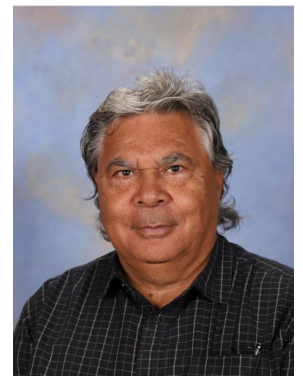

Careers Adviser, Mr Brian Bates. If you require help with any matter related to a future career, students should visit the Careers Adviser, who will assist them. Parents/Carers can contact the Careers Adviser by phoning the school.

Senior Administration Manager

Mrs Parree Cadd



The **School Administrative Support Staff** are available to provide parents/carers and students with general information on school activities. Appointments to see the Principal and other members of staff should be made through the Front Office. Enquiries about attendance, uniforms, payment of monies and lost property should be directed to the Front Office.

Aboriginal Education and Support Team

AEO

Mrs Vicki Adams



Aboriginal Education, Mrs Vicki Adams. The Aboriginal Education Officer's (AEO) role is to assist Aboriginal children in all aspects of their school life.

Vicki works closely with students, teachers, and parents to help improve Aboriginal Education and Cultural Awareness and to improve the retention rates in Aboriginal students.

They also run a girl's group 'AACES' that engages Aboriginal and Torres Strait Islander girls from all years participating in various activities such as arts and craft, healthy eating, health checks and culture.

The AEO office is located next to the Clontarf office. Parents/carers can contact them by phoning the school.

Clontarf

Mr Ayden Pettitt



Clontarf, Mr Ayden Pettitt and Mr Sheldon Hall. The Clontarf Foundation is a nationwide Aboriginal and Torres Strait Islander men, empowerment, and wellbeing program.

Using a comprehensive approach; of supportive relationships, welcoming environments and a diverse range of activities; the Clontarf Foundation aims to develop the self-esteem and confidence approach of young Aboriginal and Torres Strait Islander men.

Participants in the Clontarf Foundation can engage in various social, emotional, academic and physical wellbeing activities, including, camps, sporting days, community days, workplace visits and health checkups. All are aimed at developing the capacity and life skills

of young Aboriginal and Torres Strait Islander men.

The Broken Hill High School Academy room is a safe, welcoming environment where positive relationships are forged between participants, staff and the wider community.

Clontarf

Mr Sheldon Hall

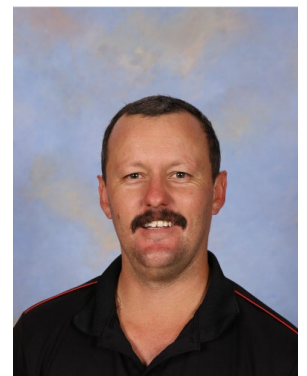

Learning Support Team

Learning Support
Mrs Natalie Hansen



Learning Support, Mrs Natalie Hansen and Mr Justin Murphy. If you have any extra learning needs and would like help with your classwork, see the Learning and Support Teachers to make a Personalised Learning and Support Plan with parents or carers so you can do your best at school. Additional support provided to complete homework and assessment tasks can be accessed through the Ross Clark Learning Centre (in-school) or the Homework Centre (Monday and Thursday after school).

Learning Support
Mr Justin Murphy

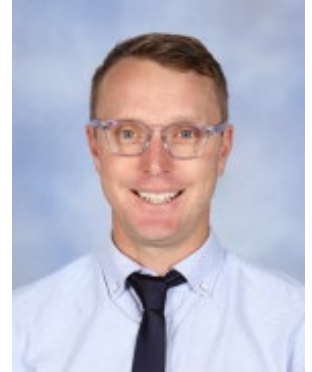

MultiLit
Ms Karen Ford



MultiLit, Ms Karen Ford and Ms Josie Tester. MultiLit stands for Making Up Lost Time in Literacy and is an intensive reading program designed to increase children's progress in reading accuracy, fluency, comprehension and spelling.

MultiLit
Ms Josie Tester



QuickSmart, Miss Laura Gladigau. The primary aim of QuickSmart is for the students to develop automaticity. QuickSmart lessons emphasise the development of conceptual understanding. Conceptual understanding is ensured by explicitly teaching strategies that emphasise the key concepts underpinning the academic skills being taught.

QuickSmart
Miss Laura Gladigau



What to do on your first day at school?

On your first day at high school, **Friday 7 February 2025**, you **will meet** in the **School Hall**. Parents/Carers are invited to attend at this time as well.

You will need to bring:

- Pen and paper. You **will not** need all your exercise books.
- Something to eat at recess and lunch (or money for the canteen).

After being welcomed by the Principal and Deputy Principal, Year 7 students will be divided into their classes and given details on school procedures and timetables.

On your second day:

1. At the beginning of the day a bell will ring and you will move to your first lesson. That will be Period 1. On Tuesdays however, the first bell of the day indicates the time to go to assembly.
2. A bell will ring at the end of each lesson and after concluding the lesson your teacher will release you to move to your next class or to recess or lunch. ***Do not worry for the first week, guides will help you find the classrooms.***

Please Note: There are no lunch passes issued at Broken Hill High School

Book Packs/School Equipment

.....
.....
• Book Packs for Year 7 are available from Spicer's Office Equipment •
.....
.....

A normal day at Broken Hill High School

The school day commences as follows;

Monday, Wednesday, Thursday, and Friday: 9:00 am – 3:28 pm.

Tuesday: 9:00 am – 2:35 pm.

Each day periods are 53 minutes.

Note:

Tuesday is an early finish: **2:35pm**

Bell Times

	Monday, Wednesday, Thursday, Friday	Tuesday
Warning Bell	8:57	8:57
Roll Call/Assembly	9:00 – 9:10 (Roll Call)	9:00 – 9:20 (Assembly)
1	9:10 - 10:03	9:20 - 10:13
2	10:03 - 10:56	10:13 - 11:06
Recess (20 minutes)	10:56 – 11:16	11:06 – 11:26
Warning Bell	11:13	11:23
3	11:16 – 12:09	11:26 – 12:19
4	12:09 – 1:02	12:19 – 1:12
Lunch 1	1:02 – 1:22 (20 minutes)	1:12 – 1:27 (15 minutes)
Lunch 2	1:22 – 1:42 (20 minutes)	1:27 – 1:42 (15 minutes)
Warning Bell	1:39	1:39
5	1:42 – 2:35	1:42 – 2:35
6	2:35 – 3:28	Staff Meetings

Year 7 Timetables are given to each student at the commencement of Term 1.

What to do when:

you have been away:

Students should be at school unless under exceptional circumstances such as illness. If a student is absent from school, the parent/carer should provide an appropriate explanation at the earliest opportunity. This can be in the form of a letter, email or phone call to the school. In each case the information provided should include the date, student's name, Roll Call class, the days and dates the student was absent, the reasons for the absence and for letters, a parent/carer signature. If the student is going to be absent from school for more than three days, a parent/carer needs to notify the school.

you arrive to School late:

Students who arrive late for school need to go to the Front Office with a note.

You will not be allowed to enter a class without a late slip.

The student should have a parent/carer note giving an acceptable reason for the late arrival. If the student does not have a parent/carer note, or the reason given is unacceptable, they will be marked as unjustified late. If students fail to report to the Front Office when late, they will be marked absent for the day and parents/carers will be informed. Students are not allowed to enter the school with any purchased drinks such as; energy drinks, coffee etc. as these will be confiscated upon signing in at the Front Office.

you feel sick:

If you get sick at school, see your ***class teacher*** and they should send you ***with a note*** to the Front Office. Staff will decide if you should go home or return to class. If going home the ***office staff will ring*** your parents/carers to arrange for you to go home.

Students should not phone parents/carers to collect them if they feel sick, as phones will be locked in their Yondr pouch as per school policy.

you need to leave early from school:

In cases of necessity, students may be granted permission to leave school before the end of the school day. A letter from parents/carers is required and should show the date it is written, student's name, the time and date when the student wishes to leave, the reason for the request and a signature of a parent/carer.

you need regular medication:

If you take regular medication and need to take a dose at school your parent/carer will need to do the following things:

1. Collect a Request for Support of a Student's Health Condition Form from the Front Office, fill it in and return to the office.
2. The parent/carer nominated on the form is to supply the medication to the Front Office of the school when required.
3. The medication must clearly display the original chemist label with the correct dosage and time medication is to be administered.

This is returned to the Front Office and the Prescribed Medications Officer will administer the medication when required.

Please be aware that your child will not be called out of class to take medication but will come to the Front Office at the appropriate time to take medication.

organising a bus pass:

If you are eligible to get the bus to and from the high school, you will need to fill in an application form, which is available online. You can apply for free school travel for next year from the start of Term 4 this year.

Step 1:

Once you have enrolled your child at high school, apply online at [transportnsw.info/ school-students](https://transportnsw.info/school-students) giving your home address and telling them which bus company the student needs to travel with between home and school.

Step 2:

The school then confirms that your details are correct.

Step 3:

They will then work on your application. You will receive an email confirming if your child is approved for free travel. If so, a bus pass will be sent to the school.

*If the bus passes do not arrive before the school year begins, students who are eligible to use the bus, can still catch the bus for the **first two (2) weeks of school** No Charge.*

Anti-social Behaviour

Broken Hill High School has proactive and reactive ways of dealing with students who harass others. Firstly, when anti-social behaviour occurs it needs to be reported and both parents/carers and students are encouraged to contact the school. We cannot help if we do not know. We have a special No Way Agreement Form, which has been very successful in avoiding repeated or further incidents. It makes it very clear that anti-social behaviour will not be tolerated. If a bully breaches the No Way Agreement, they may be suspended. Secondly, we have several programs related to preventing anti-social behaviour. Relationship and friendship dynamics is taught in PE and in our Values lessons in Year 7. The Year Adviser addresses explicitly how to deal with anti-social behaviour.

Stymie is an anonymous harm reporting tool that schools are proactively using to support their students to say something without fear. Stymie works with school communities both nationally and internationally, to connect students with their empathy and conscience so that they can, in an empowered and courageous way, enhance or change the culture of care in their school.

Stymie has been built to support existing student well-being/pastoral care frameworks in schools and was built in consideration of the Australian Student Wellbeing Framework and the recommendations from the Australian Covert Bullying Prevalence Study.

Please use the following code for Broken Hill High School:



Emergency Procedures

General evacuation of all the buildings will be signalled by an announcement over the PA system. Students are to follow the instructions of their teachers and line up in designated areas on Upper Tramway. Other procedures are in place to handle various types of emergencies. Emergency procedures are practiced at least once a year.

Communication

Broken Hill High School uses a system called School Bytes. You are now able to register for access to the School Bytes Portal via this link: <https://portal.schoolbytes.education>

We use School Bytes portal and email as our primary communication platform for finance and permissions. It offers a simplified way for you to give permission for events, add them to your calendar, access important information and make online payments directly to the school from your device.

Upcoming events and excursions can also be found on our website here; <https://brokenhill-h.schools.nsw.gov.au/> and is regularly updated with copies of permission/information notes along with other booklets handed out during the school year.

Please ensure your email address is correct, as this is another way we send home information and keep you updated with any changes.

Our Parent Portal on Sentral can be found here; <https://brokenhill-h.schools.nsw.gov.au/parent-student-portal.html> and is a vital tool for communicating. Through the Parent Portal parents/carers can message teachers, see your child/ward's timetable and school reports as they are no longer printed and sent home.

Once your child/ward has commenced school, parents/carers will be emailed a letter with a link and access codes to link your child/ward's information, please make sure you do this, as this is where urgent notifications are sent home. If you have any issues accessing these tools, please contact the school and we will give you further assistance.

Please also like our Facebook page. This is updated with important information, photos of activities happening at school and information about upcoming events.

Newsletter

The school newsletter, *Barrier Blast*, is available online via the school website. Arrangements for a hard copy can be organised by contacting the school. *Barrier Blast* contains reports by the Principal and Deputy Principal and other important information about school activities.

Homework

The purpose of homework is learning. It assists students to build on what they have already learnt in the classroom and prepares them for the next stage of learning. Homework is also useful for teachers, as it assists them to assess the progress of their students. Finally, it is an important aspect of the school-home partnership, enabling parents/carers to support their children while they learn. The most valuable work a student can do at home is self-directed, organised study. This is a measure of progress towards independence as a learner.

Leadership - Student Representative Council (SRC)

This is a group of students who are elected to represent their year and who meet regularly to discuss matters affecting students at Broken Hill High. Students from each year group, are elected by their peers annually. Students are nominated by staff and students and need to complete an application form. Members of the SRC are involved in fundraising and other leadership activities. Student leaders also include our School Captains and Vice Captains.



Peer Support Program

Peer Support Day activities for Year 7 will be held towards the end of Term 1. The students will really enjoy this experience and will get to know each other in a challenging and fun-filled environment under the care of expert staff. Further information will follow in the New Year.

Peer Support leaders will meet with their Year 7 group once a week throughout Term 1. They will lead the group through several self-esteem and relationship building activities.

Parent/Teacher Nights

Parent/Teacher Nights are held in the middle of the year to enable parents/carers to receive feedback on their children's academic progress. Parents/Carers will receive advice about the dates of these meetings in Term 1.

Parents/Carers and teachers may arrange a meeting to discuss a student's progress at any time throughout the year. Please contact the Year Adviser to arrange any meetings.

Reports

These are issued to students at the end of Semester 1 and Semester 2. If a report has not been received by this time, please contact the relevant Year Adviser.

Reports are issued via email with your child/ward's report attached. The report will be sent to the nominated email address on file. Also, a notification via the Sentral Parent Portal will be received advising that your child/ward's school report is available to view and download.

After receiving notification of your child/ward's school report and you would prefer a printed copy, please contact the school and a copy will be printed and sent home with your child/ward.

Vaccinations

The NSW Adolescent Vaccination Program for all Year 7 students will be offered:

- diphtheria, tetanus, pertussis (whooping cough) vaccine
 - **as a booster dose for all students**
- chicken pox vaccine
 - **as a catch-up for students who have *not* had chickenpox**
- human papilloma virus vaccine (HPV)
 - **3 dose course**

Students cannot be vaccinated at school unless a completed and signed consent form is returned to the school. Further information packs and consent forms will be sent early in the New Year.

If your child misses one or more of the vaccinations on the scheduled dates please contact the Department of Health or your local Health Care Professional or visit the Department of Health website at:

http://www.health.nsw.gov.au/PublicHealth/Immunisation/school_prog/index.asp

A record of vaccination will be given to your child at the time of each vaccination. Please keep these for your records and provide a copy to your local doctor.

Please note that these vaccinations are provided *free* only while your child is in Year 7.

English

The aim of English in Years K-10 is to enable students to understand and use language effectively, appreciate, reflect on and enjoy the English language and to make meaning in ways that are imaginative, creative, interpretive, critical, and powerful.

Course Requirements

As the focus of learning in each Stage, students are required to engage meaningfully with:

- at least 2 works of extended prose (including at least one novel)
- at least 2 collections of poetry
- at least 2 films
- at least 2 drama texts (including at least one Shakespeare play in Stage 5)
- a range of types of texts inclusive of short prose, visual, spoken, multimodal and digital texts.

Across each stage, the selection of texts must give students experiences of:

- a range of fiction and non-fiction texts that are widely regarded as quality literature
- a range of texts by Australian authors
- a range of texts by Aboriginal and Torres Strait Islander authors
- a range of quality texts from around the world, including texts about intercultural and diverse experiences[1]
- a range of cultural, social and gender perspectives, including from popular and youth cultures
- texts chosen by students for personal interest and enjoyment.

Requirements

- 1 x 320-page A4 exercise book.

Mathematics

The aim of Mathematics in Year 7 is to develop in students:

- confidence in doing Mathematical activities
- knowledge, skills and understanding in certain specified areas
- awareness of the place of Mathematics in solving problems of everyday life and in contributing to the development of our society.

Homework

Students may receive homework to consolidate concepts taught in class. Parents and carers are encouraged to view their children's workbooks regularly to check their progress and assist with the completion of activities at home.

Course Content

- basic geometric concepts (recognition of shapes/solids, use of instruments, terminology)
- introductory algebra (language, patterns, graphing)
- introduction of statistics (interpretation, collection/analysis/presentation of data)
- measurement of quantities (length, time, mass, area, volume, etc.)
- problem solving techniques
- operations with numbers (fractions, decimals, integers, percentage etc.).

Assessment

Regular tests and assignments on class basis, as well as formal tests each Term are used to assess the outcomes of this course.

Requirements

- 1 x 240-page A4 exercise book.
- 1 x set of Mathematical instruments.
- Ruler, pens and pencils.
- **1 x scientific calculator (available from the Front Office for \$22).**

Students will require a scientific calculator for the remainder of their secondary studies. While it is not compulsory to buy through the school it is **strongly recommended to wait and purchase one during Term 1**. The price is competitive due to our ability to buy in bulk. Should you wish not to take advantage of buying through the school, you are requested to verify the model required with the Head Teacher Mathematics to avoid purchasing the incorrect equipment.

Note - Year 7 will sit the NAPLAN Australia-wide assessments in Mathematics during Term 1.

Science

This subject aims to provide experiences in Science which will contribute to the development of children. It hopes to create an awareness and interest in the nature and behaviour of people and the environment.

Course Content

The concept of the scientific approach to problem solving is introduced.

There is an emphasis on practical work and the use of experimentation to investigate various concepts in Science.

Topics relating to Measurement and Measuring instruments, Atoms and Elements, Life Forms, Energy, Astronomy, Compounds and Mixtures and the Earth's Atmosphere will be studied.

Assessment

Students will be assessed according to the outcomes of the course. These outcomes will be based on tests, practical work, assignments, and course work.

Knowledge and Content

- use laboratory equipment appropriately for Science practical exercises
- keep accurate and up to date records of classroom work
- recognise and use appropriate units of measurement and interpret a scale
- demonstrate scientific knowledge and skills in the areas of:
 - force fields
 - living things
 - solar system
 - water
 - particle theory
 - separation
 - cells
 - energy.

Requirements

- 1 x red and blue pen.
- 1 x lead pencil.
- 1 x eraser.
- 1 x ruler.
- 1 x 240-page exercise book.

It is a requirement of the NSW Department of Education that students carrying out practical work have their feet protected by shoes with stout uppers. Preferably, these shoes should be constructed of leather to provide maximum protection. Safety glasses must be worn when required.

History and Geography (HSIE)

All students in Years 7 and 8 must complete a minimum of 100 hours of History and 100 hours of Geography within the KLA of Human Society and Its' Environment.

In Year 7 students will complete:

- **One Semester (half year) of History.** A study of History provides opportunities for examining events, people, and societies from ancient, medieval, and modern times, including twentieth-century Australia. Students explore the nature of history, how historians investigate the past and the importance of conserving our heritage. Students learn to apply the skills of investigating history, including analysing sources and evidence.
- **One Semester (half year) of Geography.** Geography allows students to develop enjoyment of and interest in the interaction of the physical and human environments. Students will develop geographic knowledge, understanding, skills, values, and attitudes to engage in the community as informed and active citizens.

Course Content Year 7

History	Geography
<ul style="list-style-type: none">• Investigating the Ancient past• Ancient Egypt• Ancient China	<ul style="list-style-type: none">• Water in the World• Place and livability

Requirements

- 2 x 128-page exercise book (one for each Semester).
- Coloured pencils, glue, lead pencils and a ruler.

Personal Development, Health and Physical Education (PD/H/PE)

The purpose of this course is to develop in each student the knowledge, skills and attitudes needed to understand, value, and lead healthy lifestyles. In doing so, the course will make a significant contribution to preparing students to take a responsible and productive role in society and to develop in them a commitment to life planning. This purpose will be achieved by developing in each student:

- self-esteem and social wellbeing
- movement skills and personal fitness
- an ability and commitment to make and act upon health decisions.

Course Content

Fundamental Movement Skills:

- Soccer.
- Athletics.
- Basketball.
- Fitness.
- Volleyball.
- Cricket.
- T-ball.
- Aquatics.
- Australian Rules Football.
- Netball.

Theory:

- Meeting new people.
- Friendships.
- Active health.
- Lifestyle diseases.
- Smoking.
- Safety (road, water, sun, sexual and cyber).
- Child protection.
- Growth and development.
- Self-esteem.

Assessment

Students will be assessed according to the prescribed outcomes. Proposed methods of assessment include:

- practical tasks
- theory based outcome tasks
- recorded observations
- National Health and Physical Education project – based learning task.

Requirements

- **Practical lessons** – A compulsory change of shirt, black shorts, sport shoes, water bottle, sunscreen, and a hat (optional). A black tracksuit is not compulsory but advisable in the winter months. A change of uniform is required for practical lessons.

Sport

Broken Hill High School runs integrated sport. This means that students have a double period per fortnight on their timetable.

The school offers a range of sports off-site to cater for a variety of individual needs and interests for example AFL, Aquatics, Basketball, Gymnastics, Netball, Volleyball and mixed sports at the YMCA.

At the beginning of the year, students will receive a general permission note to allow them to participate in sport outside the school grounds for the full school year. If a student does not have this note signed by a parent/carer they will not be able to leave the school grounds. Students will also be given a specific information sheet prior to participating in each sport with the specific requirements for that sport for example Aquatics.

Each sport and transport are paid by the school to allow free sport options for all students.

All students must act within the school's Core Values of Respect, Responsibility and Cooperation. This includes:

- Returning permission notes.
- Attending on a regular basis.
- Moving to and from venues in a safe manner.
- Following teacher/instructor instructions.
- Being courteous to members of the public.
- Working cooperatively with peers.
- Applying themselves with diligence in physical activities.

DET Policy – NSW Department of Education Sport and Physical Activity policy states students in Years K-10 participate in a minimum of 150 minutes of planned moderate activity with some vigorous physical activity across the school week. This time includes planned weekly sport. Schools are also encouraged to provide Years 11 and 12 students weekly access to a minimum of 150 minutes of moderate activity with some vigorous physical activity and sport.

French (LOTE)

Bonjour! In Year 7, students at BHHS will explore aspects of French language and culture for the entire year.

In order to learn to communicate in a second language and develop a greater understanding of another culture, students will be introduced to elements of daily life in France through images, online media, documentaries, movies and hands on learning.

Students will also learn how to communicate in French through scripted role-plays, games, class discussions, posters, creative work and group activities.

Course Content

Students will study the Stage 4 Year 7 French course for both semesters of 2025. This meets the mandatory 100-hour syllabus requirements expected by the NSW Board of Studies and NSW Department of Education and Communities.

Units of work

- Getting to know you – greetings, basic information numbers, Francophone countries.
- Animals – pets, describing words, animals.
- My Family – family members, likes and dislikes.
- The French Revolution – understanding Bastille Day and history of France.
- Sport and School – verbs, timetables, preferences.

Assessment

Year 7 students will have their progress tracked against syllabus outcomes and will complete a variety of assessment activities including creative tasks, research, in-class tests, role plays and ICT presentations.

Requirements

- 1 x 320-page A4 exercise book.

Music

Music in Year 7 is designed to be as rewarding and enjoyable as possible as well as developing the basic skills and concepts in reading, writing, performing, and listening to music.

Year 7 students are encouraged to be involved in Music department activities such as choir and various performance opportunities throughout the year.

The mandatory Music course at Broken Hill High School is fully completed in Year 7. Students can select Music as a subject from Year 8 onwards.

Course Content

Music in Year 7 consists of the following:

- performance basics on selected instruments – drum kit, guitar, and keyboard
- introduction to a variety of instruments - orchestral, rock band, electronic etc.
- performing (school, class, individual, singing)
- composition of rhythms and melodies in groups and individually
- excursions and school activities throughout the year
- basic theoretical concepts of music:
 - duration (notes, rhythm, beat, drums etc.)
 - pitch (the music stave, reading music, melody, harmony etc.)
- it is expected that students participate in school-based activities.

Assessment

Assessment is based equally in the areas of Performance, Composition, Musicology and Listening to assess student progress in relation to the prescribed course outcomes. Strategies will include topic assessments, performance assessment, and continuous assessment throughout the year such as homework, bookwork etc.

Requirements

- 1 music exercise book that includes manuscript pages is essential.
- \$15 subject fee to assist with the purchase of strings, music and drumsticks, maintenance etc. - **which should be paid by the end of Term 1.**

Technology

This course looks at the study of Technology through Design. It involves practical experiences in designing, making, and evaluating projects. Computer and graphical skills are integrated with each design project.

Course Content

This course has a compulsory two-year framework so students will cover units from all the following areas of study:

- built environments
- products
- information and communications.

Assessment

Students will be assessed according to the outcomes of the course. These outcomes will be evaluated through a continuous assessment and will be based on written reports, oral assessments, classroom observation, design projects and folios, research assignments and computing skills.

Personal Protective Equipment (PPE)

It is a requirement of the NSW Department of Education that students carrying out practical work have their feet protected by shoes with stout uppers. Preferably, these shoes should be constructed of leather to provide maximum protection. Safety glasses must be worn when required.

The Support Unit

The Support Unit at Broken Hill High School was established in 1995. In 2025, the Support Unit will have six classes on-site that cater for students with a range of formally diagnosed disabilities. This may include intellectual disabilities, Autism, sensory impairments such as vision and hearing, physical disabilities, or mental health issues. There will also be one class of-site, located at the West Campus in Rakow Street.

The Support Unit is staffed by one Deputy Principal, one Head Teacher, six full-time teachers, two part-time teachers and six full-time School Learning Support Officers (SLSO's).

In consultation with parents/carers, teachers develop an Individual Transition Plan (ITP) for each student based on their individual needs. Focus areas include developing academic skills, communication and social skills, independent living skills and work readiness for life after school.

Students enrolled in the Support Unit attend age-appropriate mainstream classes such as Science, HSIE, PD/H/PE, Music, Art, Agriculture and Wood Tech, with support as required. They also participate in all whole school activities such as roll call, assemblies, sport carnivals and the Student Representative Council (SRC).

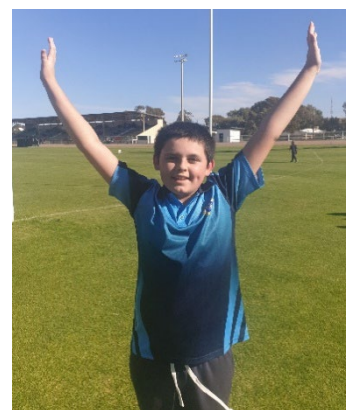

The BHHS Student Wellbeing System

The aim of our Student Welfare and Behaviour system is:

- to develop a sense of dignity and worth within each individual
- to develop a sense of personal and social responsibility for student actions and decisions
- to improve students' ability to communicate effectively
- to assist students in developing caring attitudes towards others
- to nurture in students a sense of enjoyment in and satisfaction for learning.

We have developed a Welfare Policy, which recognises student rights and responsibilities and achievements and has a caring approach with strong support mechanisms when problems occur.

Achievement Award Scheme

The Achievement Awards are to encourage student performance in academic ability, social skills, community participation and cooperative attitudes.

Recognition can be awarded by teachers for:

- a sustained improvement in attitude, performance, or conduct
- full attendance for a Term
- full school uniform for a Term
- positive contribution or valuable service.

Sport, Culture and Citizenship Awards:

- representing the school at a high level in public speaking, debating, or sporting teams
- extracurricular activities, including ANZAC Day, Red Shield Appeal
- high achievement in State and National competitions
- major contribution to school performance evenings.

Broken Hill High School Core Values

Be Respectful

Be Responsible

Be Cooperative

We follow a Positive Behaviour for Learning (PBL) Model.

The process focuses on improving a school's ability to teach and support positive behaviours for all students.

As part of this process, we have developed our core values that we use daily in the school when dealing with all students – be respectful – be responsible – be cooperative. We encourage all students to follow these values within the school.

In Year 7 in 2025, students will have one lesson a fortnight, which will be their values lesson. In this class students will work their way through lessons about the core values, will undertake some workshops on bullying and resilience and do some activities in relation to mind matters. These lessons are designed as part of our pastoral care program.

Mobile Phone Policy

A Yondr Pouch will be issued to your child/ward on their first day of school. The Yondr Parent – Student Agreement form needs to be signed and returned to school with your completed enrolment forms. If it is not signed and returned, then your child/ward will **not be permitted** to bring a phone to school.

Our goal with Yondr is to improve teaching and learning through the delivery of syllabi content and best instructional practices in a safe and effective learning environment by making our school a phone-free space.

We would like to remind you of a few important guidelines regarding your student's Yondr pouch. Firstly, we would like you to know that we take the education of your child/ward very seriously.

Please read the following and sign below:

1. The Yondr pouch is the property of Broken Hill High School. Your Yondr pouch, issued by the school, is to be used for the sole purpose of storing and locking your phone and that the pouch remains locked during the entire school day. If payment for canteen items is required, your child/ward must see the Deputy Principal to arrange for this to happen.
2. Your child/ward will remain in possession of their assigned Yondr pouch with phone inside throughout the school day but will not be able to use them until they are unlocked at the end of the school day.
3. If your child/ward is involved in tampering, destruction or damage of any kind to the Yondr pouch, phone privileges will be removed until the Yondr pouch is replaced. A parent/carer will be required to attend school to pick up the phone. Tampered pouches will need to be replaced at the cost of **\$20** by the parent/carer.
4. A student shall not intentionally cause or attempt to cause damage to school property (Yondr pouches), or the property of another person, or steal, attempt to steal, or knowingly be in the unauthorised possession of the property (Yondr pouch) of another student. If your child/ward has damaged or stolen the Yondr pouch of another student, you will be responsible for the cost of replacing the pouch before the student is allowed to bring a phone to school.
5. Your child/ward must have their Yondr pouch each day in order to bring a phone to school. If your child/ward loses the original Yondr pouch that is given, a replacement pouch will cost **\$20**. There will be random pouch checks and your child/ward must be able to produce their pouch when asked. This will be done by Broken Hill High School staff and Yondr staff.

The School Library

All students are welcome before school from 8:30am, at recess and lunch times. There is a huge range of fiction, non-fiction, picture and reference books available for viewing and borrowing. We also have desktop computers available for use, a variety of magazines to read and printing is available for school assignments. Our new graphic novel collection is expanding rapidly.

The Premier's Reading Challenge is open to students in Years 7, 8 and 9. It finishes each year at the end of August. It requires reading 20 books, 15 from the Premier's Reading Challenge list and 5 of your own choosing. Books are marked with a sticker to help you know which ones to choose.

Book Week is celebrated with activities each year.

Each Friday at lunchtime is Games Day.

Our Reading Room is a comfortable, inviting and inclusive reading/quiet space.

Homework Centre is held in the Library on Monday and Thursday afternoons from 3:30 – 5:00pm.

If you and your friends would like to be a Library Monitor, you are very welcome, and it is a great help.

Librarian

Ms Jodie Clarke

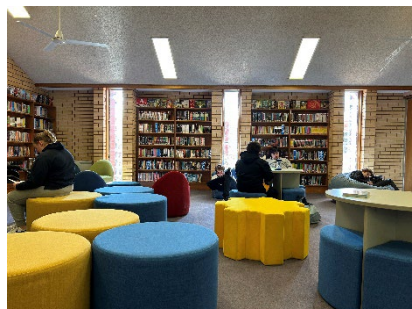
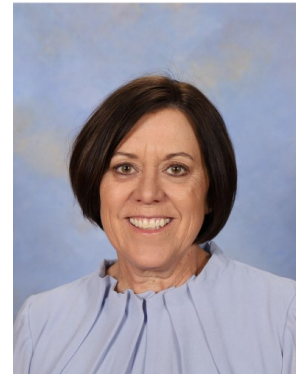

School Uniform

All students are expected to wear school uniform at school and on school excursions. Parents/Carers will be informed of consistent or serious breaches of the dress code. Students may also be asked to return home to change into the required clothing (seniors) or parents/carers asked to bring the required clothing to school (7-10).

The wearing of identifiable uniform and colours also represents an important child protection requirement. The legal obligation to protect all users of the campus site will override any objection to wearing a uniform.

Students are expected to maintain a high standard of personal hygiene and neatness. Clothing and accessories should be clean, safe, modest and in reasonable condition.

- **Junior Uniform:**

- **Summer Uniform**

- Black shorts. **No Micro Short.**
- Navy blue Broken Hill High School jumper with school emblem can be worn on colder days (No brand name or names on jumpers are acceptable).
- Navy blue polo shirt with collar and sleeves (emblem preferred).

- **Winter Uniform**

- Plain black pants.
- Navy blue polo shirt with collar and sleeves (emblem preferred).
- Navy blue Broken Hill High School jumper with school emblem (No brand name or names on jumpers are acceptable).



Excursion Uniform

Full school uniform will be worn for all official functions and visits.

Sports Uniform *(On sport day only)*

- Black shorts. **No Micro Short.**
- Navy blue polo shirt with collar and sleeves with school emblem (bring a spare shirt to change into on sport day).

On cold days, plain black tracksuit pants may be worn with school jumpers.

Uniforms can be purchased through the following:

- Fast Print – Gypsum Street, Broken Hill.
- Totally Workwear – Rakow Street, Broken Hill.
- Barossa Knitting Mill - York, Duff Street, Broken Hill.

Footwear

Students must wear sturdy, fully enclosed, shoes or sturdy, fully enclosed joggers. Thongs, canvas loafers, sandals, clog-style, and scuff-style footwear are not permitted, as, under Workplace, Health and Safety legislation, such footwear would represent a foreseeable risk of injury given the nature of school sites.

Legal requirements for appropriate footwear will override any objection students may have. Depending upon their age and the specific circumstances, students wearing inappropriate footwear may be required to return home to obtain enclosed footwear or their parents/carers may be contacted to deliver appropriate footwear to them at school before they are allowed to attend lessons.

Students without appropriate footwear will not be permitted in some classrooms where a risk of safety exists e.g., science labs, kitchens, workshops, or art rooms.

Hats

Hats and sunshades are acceptable for this climate and are acceptable for wear outside the classroom.

Parents/Carers, we draw your attention to the fact that this will be the cheaper option in the long run. All clothing items are to be clearly labelled with the student's name (especially jumpers and jackets). School Uniform must be worn at all times. However, if a student is out of school uniform a note explaining why must be supplied.

School Contributions

General Information

School Invoices are emailed to families in Term 2 and Term 4. They can be paid at the Front Office between 8.30am and 3.30pm with Cash/Cheque/EFT or Online via School Bytes portal (please see below information) or via our website <http://www.brokenhill-h.schools.nsw.edu.au/> just select make a payment and follow the instructions.

Students may pay at the Front Office before school, recess, and lunchtime.

Contributions are as follows:

- General Contribution \$20.00
- Subject Fees \$40.00

General contributions

General contributions are voluntary contributions, which greatly assist in maintaining and increasing the quality of education for your student. Contributions are used for the purchase of library books, student recognition programs, teaching resources, computer software and hardware and other resources.

Students can pay school fees or any payments before school, recess, or lunch of any day. Receipts will be emailed. Payment of school contributions and fees can be made by cash, cheque, EFTPOS (no cash advances available) or online using the School Bytes portal.

What is the School Bytes portal

The School Bytes portal provides flexibility for you to conveniently:

- Make school payments online (including paying for multiple siblings at once)
- Use a family credit to pay for an activity or school contributions
- Download a receipt for payments made
- View all historical payments in one place
- Complete and submit digital permission notes
- View the status of all permission notes
- Request a refund if required

This can be done where you want at any time: day or night.

Through the portal, you will easily be able to download a receipt once a payment has been made and have access to view all historical payments when needed. Online payments are processed in real-time and can be viewed by school staff immediately.

While our preference is for payments to be made via the portal, we will still accept payment via cash, cheque, money order and EFTPOS.

Financial Assistance

Should you have problems paying these contributions the school may be able to provide assistance. Applications can be made through the School Administration Manager in the Front Office of the school. Help can also be arranged for the purchase of school uniform and books.

Parents/Carers should note that costs of travel and admission for excursions are not included in school contributions.

Parent and Citizens Association

A large percentage of you no doubt has experienced being involved with a Parent and Citizens Association during your child's primary years, and this fun can continue throughout their high school life.

High school also operates a Parents and Citizens Association, and you are always most welcome to come and join.

I personally extend the invitation to you as a new parent of Broken Hill High School.

Parents and Citizens Association membership cost is \$2.00 and ensures that you are informed of events and issues within the school firsthand. This can only make your life and that of your child richer and more rewarding for the education experiences that he or she will have at Broken Hill High School. We meet on the third Monday of each month at 7pm in the Conference Room near the Front Office.

Our Parents and Citizens Association is very active within the school, participating in school committees, selection of staff when vacancies occur, assisting the canteen ladies and fundraising ever valuable dollars. The fundraising is for the benefit of our children's educational needs with much needed purchases and funding events and activities.

Join in and have your say.

I personally look forward to meeting with you and welcoming you to Broken Hill High School.

Mrs Jodie Hartwig
Parents and Citizens Association President

Broken Hill High School



MARGARET ANSTEE CANTEEN PRICE LIST

HOT FOOD		THE GOODS		SNACKS		DRINKS	
Pie/Pastie	\$4.50	Chicken/Ham &	\$6.00	Assorted Chips	\$2.00	Water - Small	\$2.00
Sausage Roll	\$4.00	Salad - Roll/Wrapper	\$5.00	Popcorn	\$2.00	Pump Water	\$4.50
Flavoured Pie	\$5.00	Salad - Roll/Wrapper	\$5.00	Arnotts Shapes	\$1.00	Nippy's Juice	\$4.00
Chicken Sliders	\$4.00	Chicken/Cheesestlaw	\$5.00	Yoghurt/Museli Bowl	\$4.00	Juice Bombs	\$2.50
Sweet Chilli Tenders	\$4.00	- Roll/Wrapper	\$5.00	Jelly Cup	\$2.00	Fruit Boxes	\$2.50
Chicken Burger	\$5.00	Chicken/Lettuce/	\$5.00	Banana Bread	\$2.00	Coke No Sugar	\$3.50
Chicken & Gravy Roll	\$5.00	Mayo - Roll/Wrapper	\$5.00	Snap Stick	\$1.00	Nippy's Flavoured	\$4.00
Hot Ham & Cheese	\$4.50	Sweet Chilli Tender	\$5.00	Zooper Dooper	\$1.00	Milk	\$4.00
Roll		Wrap		TNT	\$1.00	Farmers Union	\$4.00
Spaghetti Bol	\$4.50	Chicken & Salad Bowl	\$6.00	Sauce	\$0.50	Iced Coffee	
Fried Rice	\$4.50	Chicken Ceaser Salad	\$6.00			Feel Good Iced	\$4.00
Lasagne	\$4.50	Salad Bowl	\$5.00			Coffee	
Pizza	\$2.00	Fruit Bowl - Large	\$5.00			Plain Milk	\$3.00
Nachos	\$4.00						
Cheeseburger	\$5.00						

You can pre-order your lunch in the morning or recess!

EFTPOS is available - \$1.50 minimum
Prices subject to change



I would like to be involved!!!

Often parents/carers of Year 7 students would like to become involved but are unsure of how they can become involved in a high school community. Perhaps all you need is a call from someone in the know or an invitation to attend a meeting.

If, as a parent/carer, you would like to be involved but are unsure how you could best become an active member of the school community fill in the slip below and return to the Broken Hill High School Front Office. A member of the Parents and Citizens Association will contact you to invite you to become involved.

Name: _____

Child's Name and Year: _____

I would like to be involved in: -

Parents and Citizens Association

Canteen – Preferred Days Please circle: Mon Tues Wed Thurs Fri

My contact details are:

Please complete and return this form to the Broken Hill High School Front Office.